

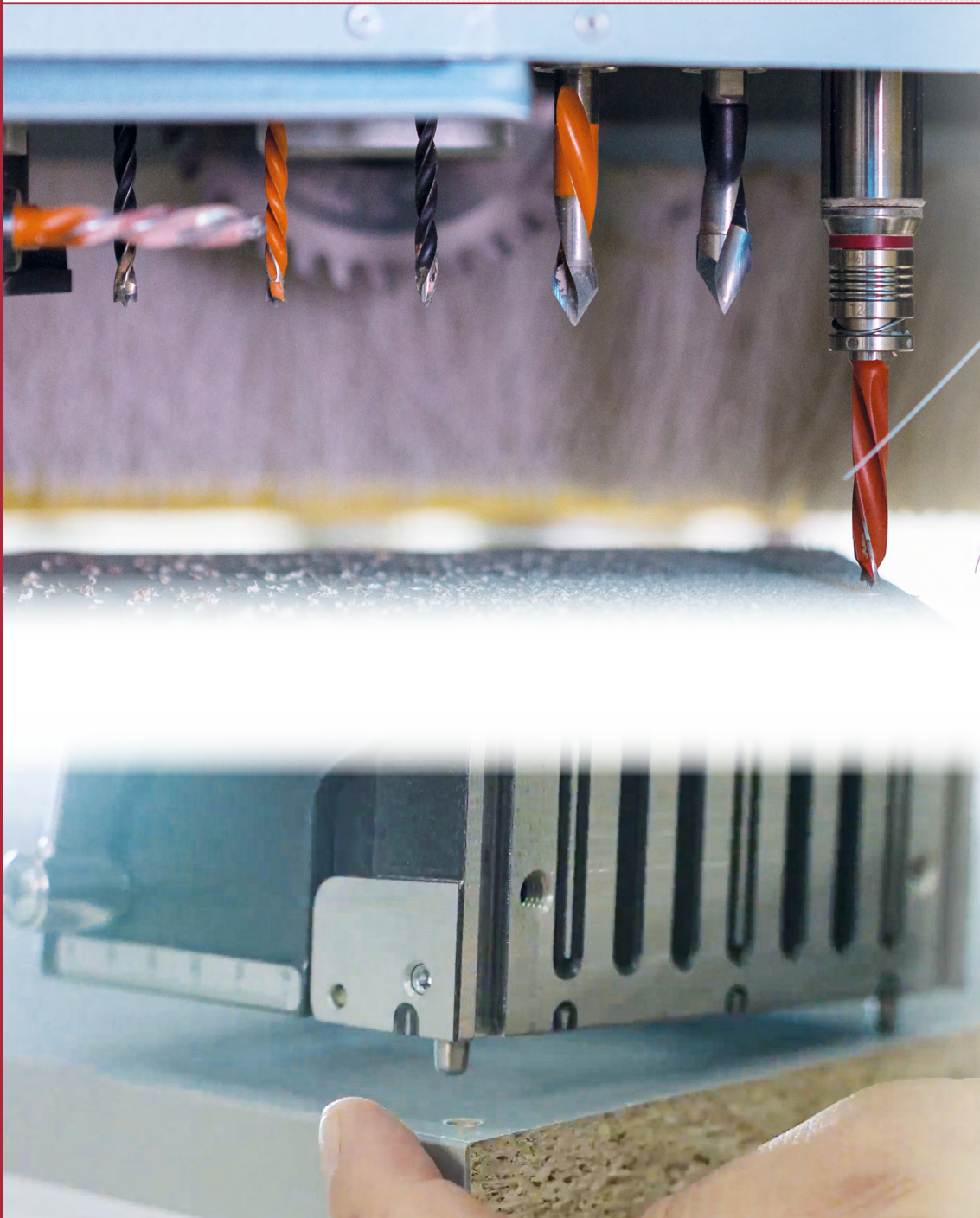

Tips tricks

Possible combination of CNC machines with Zeta P2



**Nesting
machines**

**CNC with 3 axes
without angle
aggregate**

**CNC with 5 axes
without angle
aggregate**



Zeta P2

Precise drilling on a CNC machine, use these drill holes to position the Zeta P2 to cut the P-System grooves. This application is especially ideal if the CNC machine is a nesting machine and or no aggregate is available. This method combines the precision and efficiency of a CNC machine and uses the simple and fast machining of a P-System groove with a Zeta P2.

Positioning drill holes for the Zeta P2

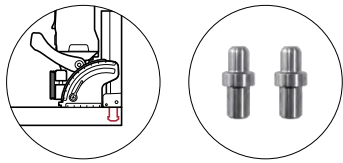

Positioning pin CNC for Zeta P2, 2 pieces

	Art. No.
Ø 5 mm	251048
Ø 8 mm	251066

How it works:

P-System groove in the surface

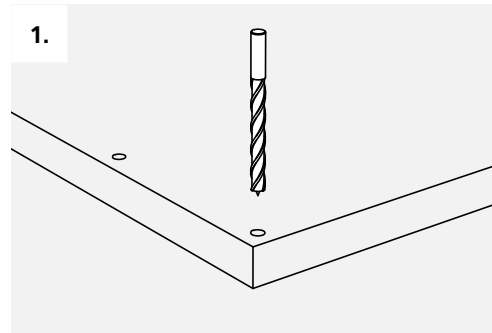

1. Drill the positioning holes with the CNC, Ø 5 mm/Ø 8 mm

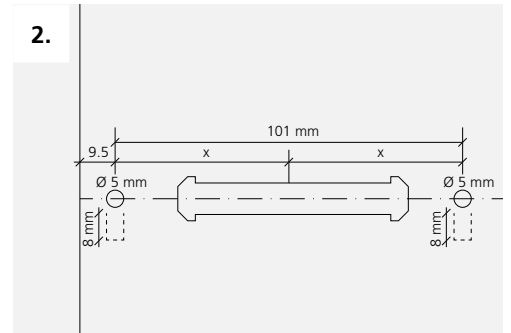

2. Hole pattern of the positioning drill holes axis spacing 101 mm

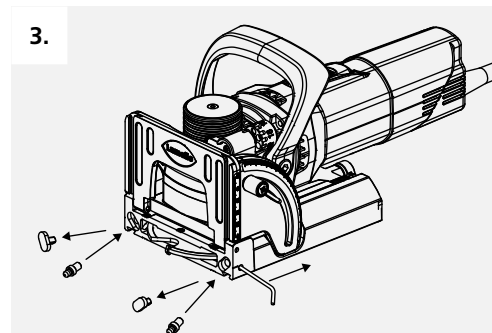

3. Insert the positioning pins in the Zeta P2

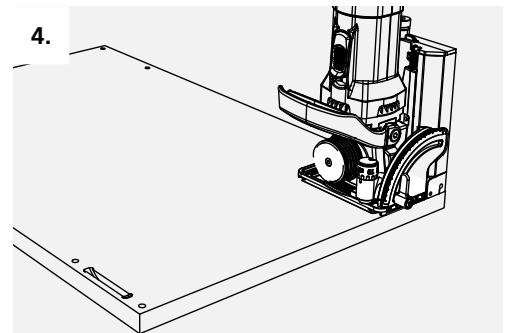

4. Position the machine in the drill holes

P-System groove in the edge

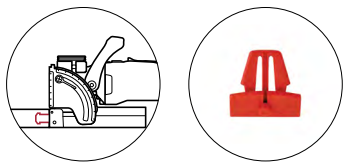

Positioning clip CNC for Zeta P2

	Art. No.
Ø 6 mm	251067

for positioning in the Clamex P access hole (6 mm)

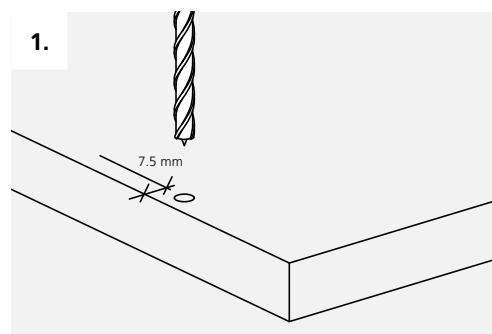

1. Drill the positioning hole with the CNC, Ø 6 mm

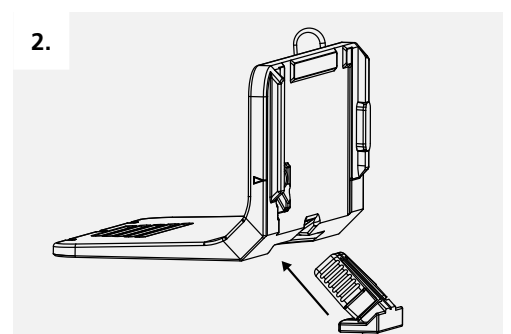

2. Insert the positioning clip

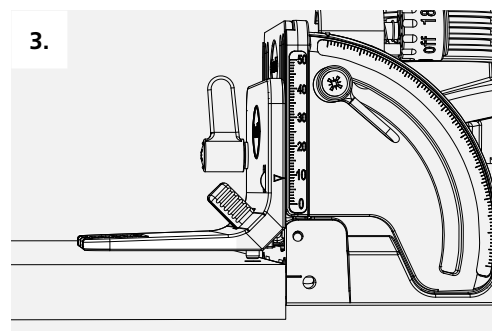

3. Insert the positioning clip in the drill hole Ø 6 mm

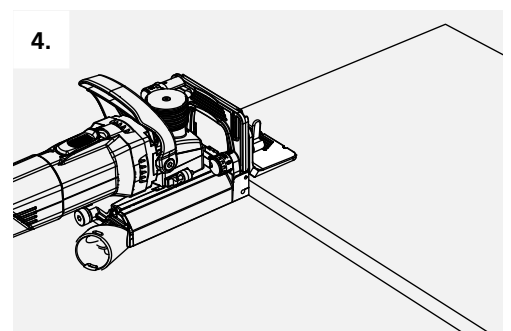

4. Cut the groove with the positioned machine